

Mounting Instruction

Recessed Mount

Drawings and pictures are for illustration purpose only.

The model you have may vary.

1. Remove the ceiling tile at an appropriate location where the product is to be installed.

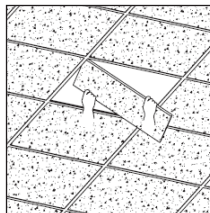

2. Put product into the ceiling channel and properly align it on the frame.

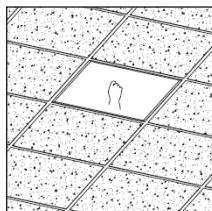
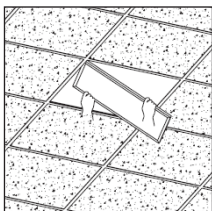

3. Bend hang buckle by 90°. Set it vertical to the rear cover of panel. Bend hang buckle's top part by 90°. Do the same for all the hang buckles.

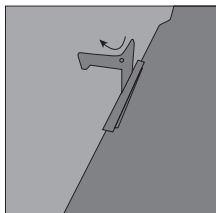
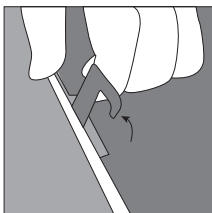

4. Secure panel to the ceiling with aircraft cable or wires capable of supporting 100lbs minimum (wire/cable not included).

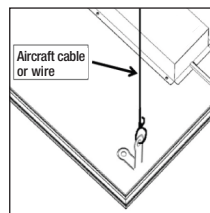

5. Remove the screw on driver cover. Connect main power supply and dimming control lines through terminals according to wiring diagram. Open one of the knockouts and connect the strain relief (included).
6. Re-install driver cover onto driver housing and secure in place with a screw.

Verbatim 5-year warranty www.verbatimlighting.com/warranty.
For support, visit www.verbatimlighting.com/support

May not be compatible with all dimmers.

For up-to-date compatibility please visit www.verbatimlighting.com/dimmer_support.

This device complies with Part 15 of the FCC rules. Operation is subject to the following two conditions: 1) this device may not cause harmful interference, and 2) this device must accept any interference received, including interference that may cause undesired operation.

- AMERICAS: Verbatim Americas LLC, Charlotte, NC 28262
- EUROPE/MIDDLE EAST/AFRICA: Verbatim GmbH, Düsseldorf Straße 13, 65760 Eschborn/Germany
- AUSTRALIA/ NEW ZEALAND: Verbatim Australia Pty., Ltd., Unit 6, 450 Princes Highway, Noble Park, Victoria, 3147 Australia Tel: +61 3 9790 8999 Fax: +61 3 9790 8955 Email: support@verbatim.com.au



Installation Guide

Safety Information

WARNING: RISK OF SERIOUS INJURY AND PROPERTY DAMAGE

- To reduce the risk of death, personal injury or property damage from fire, electric shock, falling parts, cuts/abrasions, and other hazards, be sure to read all warnings and instructions included with and on the fixture box and all fixture labels.
- The installation, service and maintenance of luminaires must be performed by a qualified licensed electrician.
- Do NOT install damaged product.
- **Make sure power is turned off at the breaker.**

- Turn off the electrical power at fuse or circuit breaker box before any installation work.
- Turn off the power when you perform any maintenance.
- Verify that supply voltage is correct by comparing it with the luminaire label information.
- Do NOT use any input power except the voltage specified on the Product Specifications.
- Do NOT install in a wet environment.
- Ensure that all electrical and grounded connections are in accordance with the National Electrical Code or your local code requirements.
- All wiring connections should be capped with UL approved wire connectors.
- Wear gloves and safety glasses at all times when removing luminaire from carton, installing, servicing, or performing maintenance.
- Avoid direct eye exposure to light source while it is on.
- Account for small parts and destroy packing material, as these may be hazardous to children.
- Ensure the fixture is properly secured to ceiling, T-bar grid, using wire or aircraft cable capable of supporting 100 lbs. minimum (wire/cable not included).
- Do NOT use this product for any purposes other than what is specified.

CAUTION: RISK OF FIRE

- Keep combustible and other materials that can burn away from luminaire and lamp/lens.
- MIN 90 SUPPLY CONDUCTORS.

Product Specifications

Part Number	LED Panel Model No.	Panel Size (Ft.)	Input Voltage (VAC)	Input Frequency (Hz)	Input Wattage (W)	Input Current (A)
99911	LED Panel PN22-W25-C40-P	2 x 2	100-277	50/60	25	0.275
99912	LED Panel PN22-W25-C50-P					
99913	LED Panel PN24-W36-C40-P	2 x 4			36	0.4
99914	LED Panel PN24-W36-C50-P					

- Operating Temperature: -4F to 104F (-20C to 40C)
- Suitable for damp locations.

Wiring Diagram

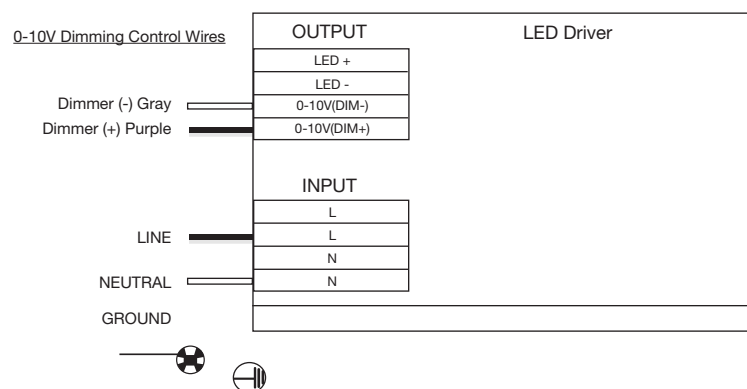

Before Installation

- Ensure that the distance between the T-bar and the actual ceiling is large enough for installation.
- Ensure that the T-bar grid size will accommodate the panel frame dimensions shown below.
- Weight load capability of T-bar framework should be verified.

Panel Size	Frame Size		Height		Weight	
	inch	mm	inch	mm	lbs.	kg
2x2	23.7 x 23.7	603 x 603	1.7	44	6.72	3.05
2x4	23.7 x 47.8	603 x 1213			13.23	6